

Pinehurst Safe Routes to School

Sidewalks and Crossing Improvements



Pinehurst Community Council
David Burgesser
March 14, 2018



Seattle
Department of
Transportation

Our mission, vision, and core values

Mission: deliver a high-quality transportation system for Seattle

Vision: connected people, places, and products

Committed to **5 core values** to create a city that is:

- Safe
- Interconnected
- Affordable
- Vibrant
- Innovative

For **all**

Presentation overview

- Current & Planned Projects
- NE 117th St/Pinehurst Way NE – Your Voice, Your Choice
 - Background
 - Existing Conditions
 - Project Goals
 - Proposal
- Next Steps

Current and Planned Projects

- Crossing improvements
 - 15th Ave NE & NE 115th St
 - Roosevelt Way NE & NE 117th St
 - Includes 20 mph school zone flashing beacons
 - Roosevelt Way NE & NE 115th St
- NE 115th St sidewalk
- 12th Ave NE sidewalk
- Northgate Neighborhood Greenway
- NE 117th St sidewalk



Crossing Improvements

- 15th Ave NE / NE 115th St
 - Ped-activated rapid flashing beacons
 - Completion in next 1-2 weeks
- Roosevelt Way NE / NE 115th St
 - “Floating” curb bulbs
 - New curb ramps
 - Delivery as soon as summer 2018
- Roosevelt Way NE / NE 117th St
 - “Floating” curb bulbs
 - New curb ramps
 - 20 MPH school zone flashing beacons
 - Delivery as soon as summer/fall 2018



New Sidewalks

- 12th Ave NE between NE 117th St & Pinehurst Playground
 - 6'-wide sidewalk with natural Drainage
 - Delivery in 2019
- NE 115th St between Roosevelt Way NE & 12th Ave NE
 - 6'-wide sidewalk
 - Rebuild painted curb bulbs at 115th/12th/Roosevelt
 - Delivery in 2019
- NE 117th St between Roosevelt Way NE & 12th Ave NE
 - Dependent upon funding availability



Northgate Neighborhood Greenway

- Safe, calm residential streets that prioritize walking and biking
- Neighborhood greenway treatments:
 - Traffic calming on residential streets
 - Enhanced arterial crossings for bicyclists and pedestrians
 - Improved wayfinding
- Currently at 10% design
- Delivery before opening of Northgate Link light rail station

NORTHGATE NEIGHBORHOOD GREENWAY Most Promising Route



Your Voice, Your Choice: NE 117th St & Pinehurst Way NE

- Project idea awarded design funding through YVYC in 2017
- Request for crossing upgrades to facilitate safe access to Hazel Wolf K-8
- Complex intersection:
 - 3 separate intersections
 - 2 N-S arterials, 1 E-W non-arterial
 - NB and SB bus traffic
 - NGW and school crossing
- “High-collision location”

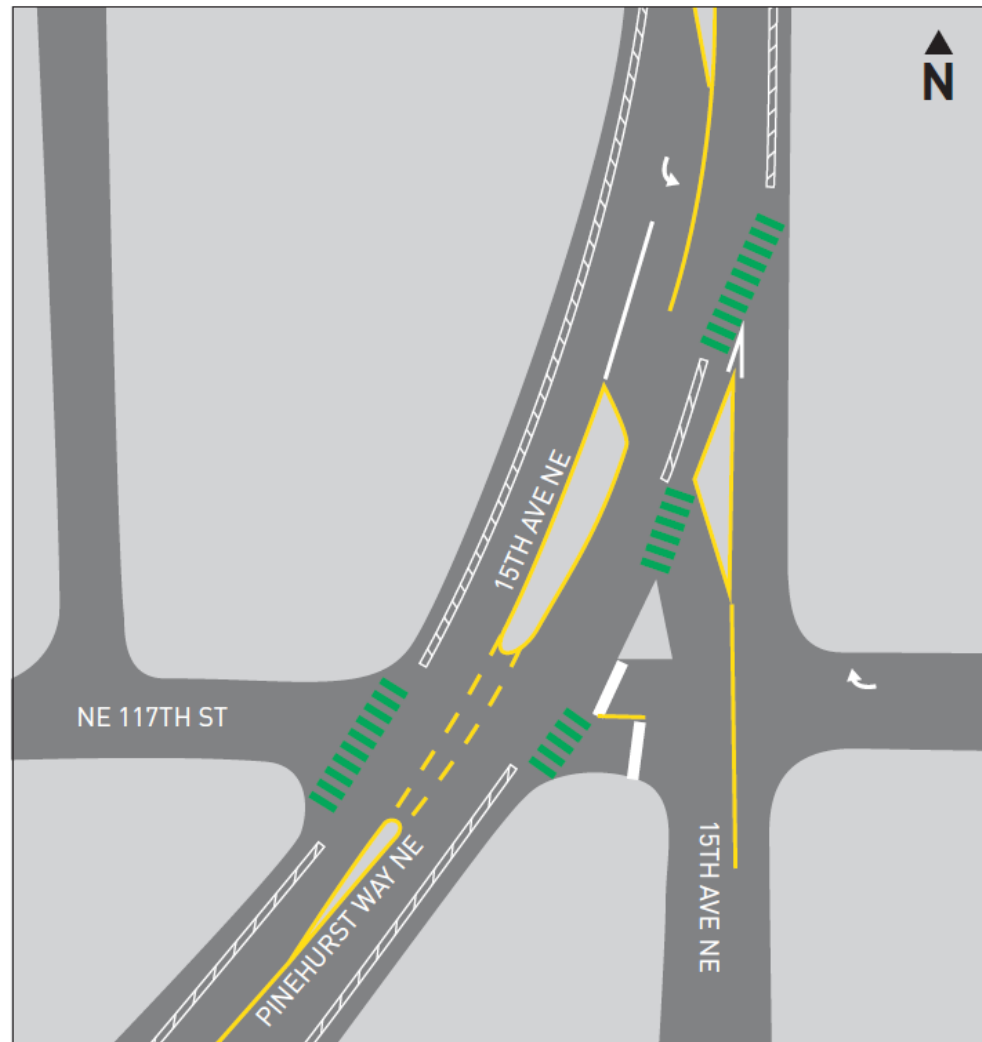



Collisions

5-year crash history (2013-2017)

- 27 total crashes
 - 10 injuries
 - 1 serious injury
- 1 recent pedestrian collision involving school student
- Primary collision pattern involved WB traffic off NE 117th St

Project Goals

- Increase safety and accessibility for all travelers
- Simplify intersection design
- Create safe and comfortable pedestrian and bike crossings that serve Hazel Wolf K-8 and the future NGW
- Relieve congestion on 15th Ave NE and Pinehurst Way
- Improve school walking route

Proposed Treatment

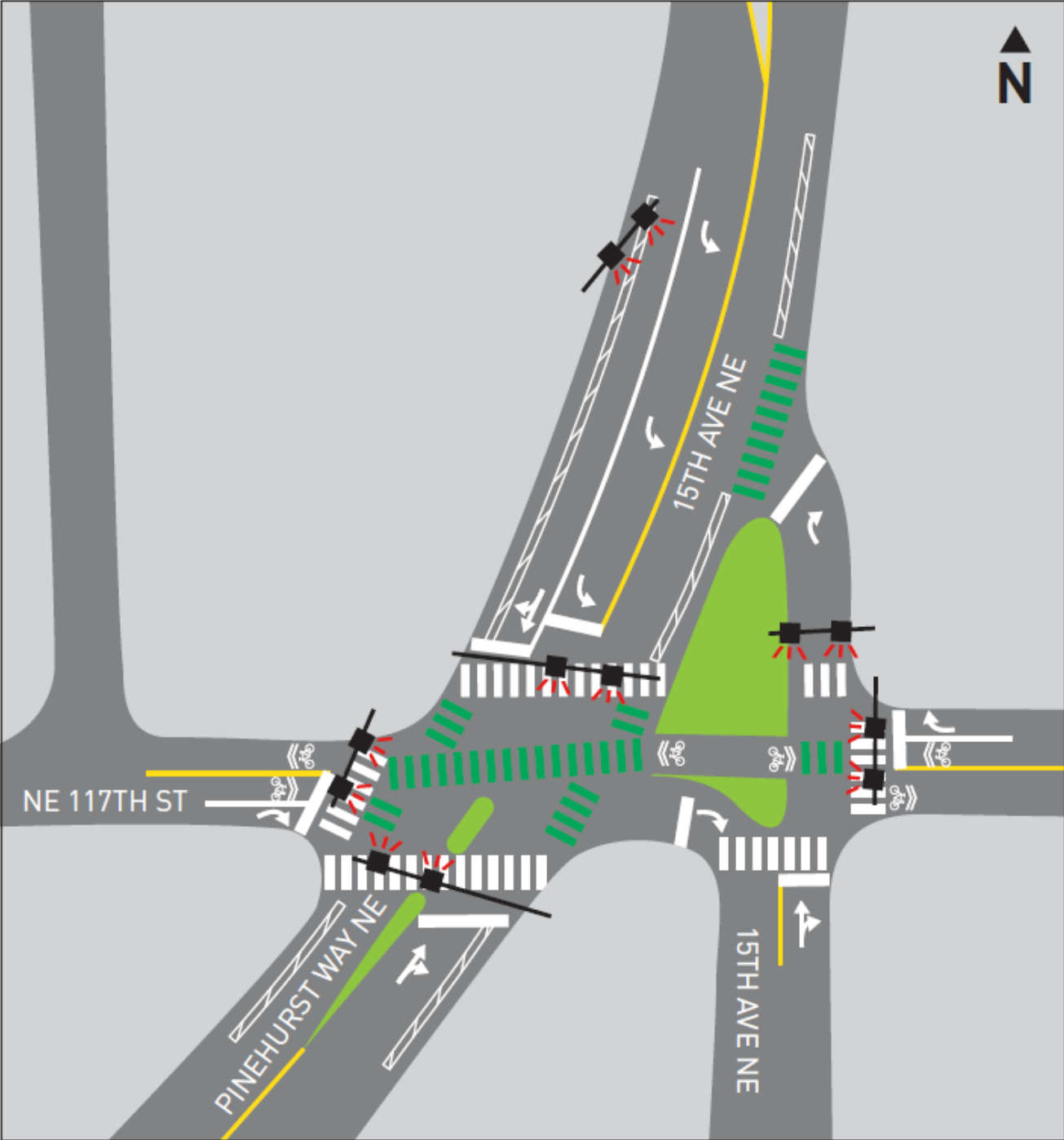

Benefits & Trade-Offs

- Benefits:
 - Protected crossing for peds and bikes on all legs
 - Simplified intersection movements
 - Reduced congestion on 15th Ave NE and Pinehurst Way NE
- Trade-Offs:
 - Restricted turn movements on/off NE 117th St
 - Elimination of connector “wedge” between 15th Ave NE and Pinehurst Way NE
 - Additional traffic directed to NE 115th St and 16th Ave NE

Existing Turning Movements

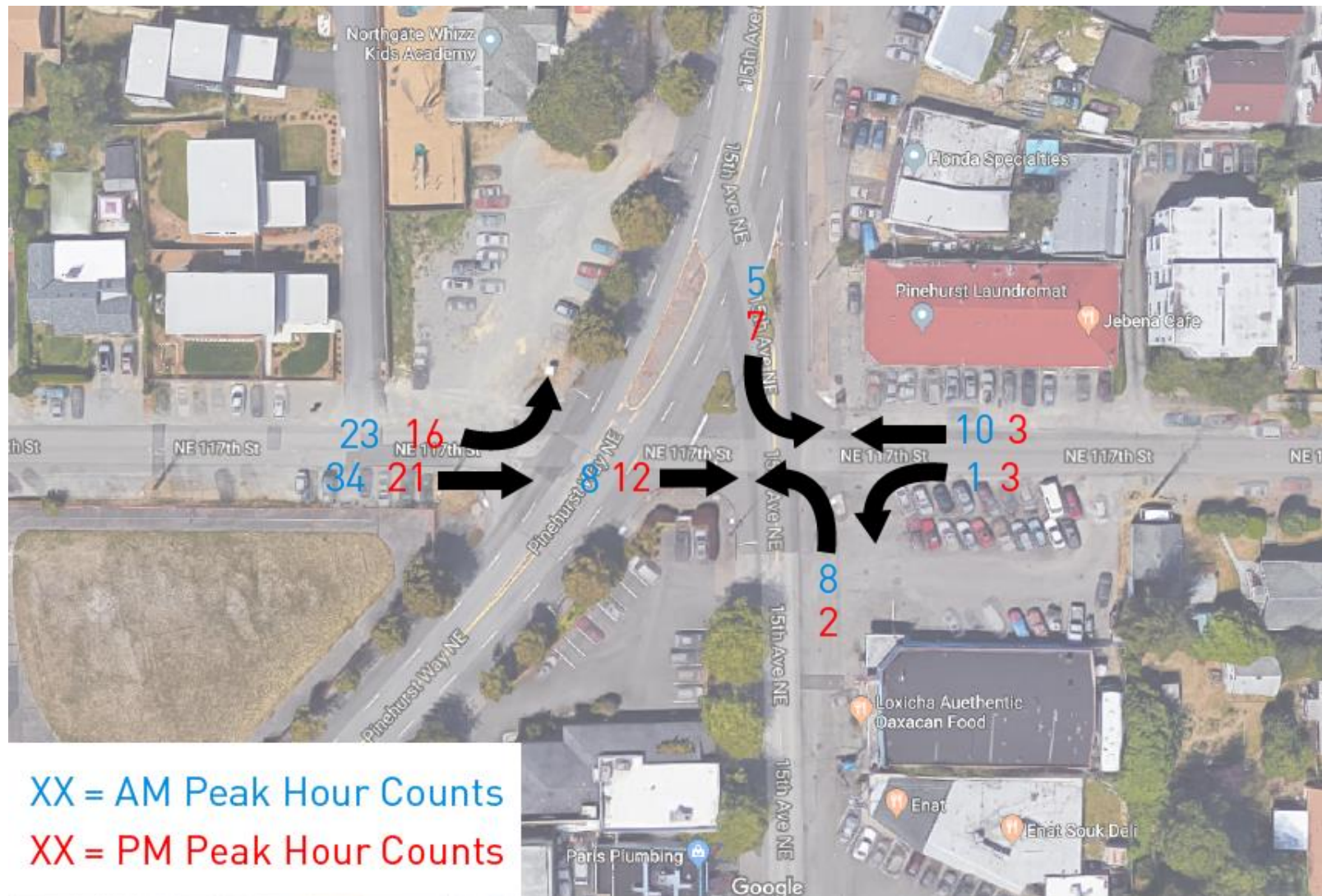

Next steps

Date	Activity/action
March-April 2018	Early concept outreach
Summer 2018	Finalize conceptual design
2019	Design
2020	Construction

Questions?

David.Burgesser@seattle.gov | (206) 684-8058
<https://www.seattle.gov/transportation/projects-and-programs/programs/pedestrian-program/>

www.seattle.gov/transportation

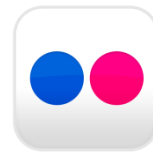

Seattle
Department of
Transportation