



Construction at N 100th St and Aurora Ave N will resume as early as January 2

WHAT'S HAPPENING NOW

Construction for the North Seattle Neighborhood Greenway at N 100th St and Aurora Ave N will resume as early as Wednesday, January 2, 2019.

Crews will install a new curb ramp on the northeast side of the intersection, and complete sidewalk spot repairs on the north side of N 100th St between Stone Ave N and Aurora Ave N. This work will last into early spring 2019. This work is weather-dependent and subject to change.

The work is part of the North Seattle Neighborhood Greenway and will provide safer, calmer residential streets that prioritize people walking and biking.

For future updates, please check the sign at the intersection, sign up for our listserv on the project webpage, or contact us using the information below.

For translation and interpretation, please call 206-684-8105.

如果您需要把下列資訊翻譯成中文，請致電 206-684-8105。

Si usted necesita esta información traducida al español por favor llame al 206-684-8105.

Nếu quý vị cần thông tin này chuyển ngữ sang tiếng Việt, xin gọi số 206-684-8105.

Kung kailangan ninyong isalin sa Tagalog ang impormasyong ito, paki-tawag lang sa 206-684-8105.

WHAT TO EXPECT

- Work in the street on weekdays, 7 AM – 4 PM
- Temporary on-street parking restrictions, with “no park” signs placed in advance
- Northbound bus lane on Aurora Ave N will be closed during weekday, off-peak hours; buses will merge with traffic. When crews pour concrete at the northeast corner of N 100th St and Aurora Ave N, the northbound bus stop will be temporarily relocated 2 blocks north. Please check King County Metro Alerts for more information.
- The east side of N 100th St at Aurora Ave N may be closed temporarily to complete work
- Those walking will be redirected around the work zone, with a flagger available to assist during work hours
- Typical construction equipment, materials, noise, dust, and activity in the work area

Note: After distribution on 12/14/18, this notice was updated with a new map of the work zone, schedule, and impacts to those riding the bus.

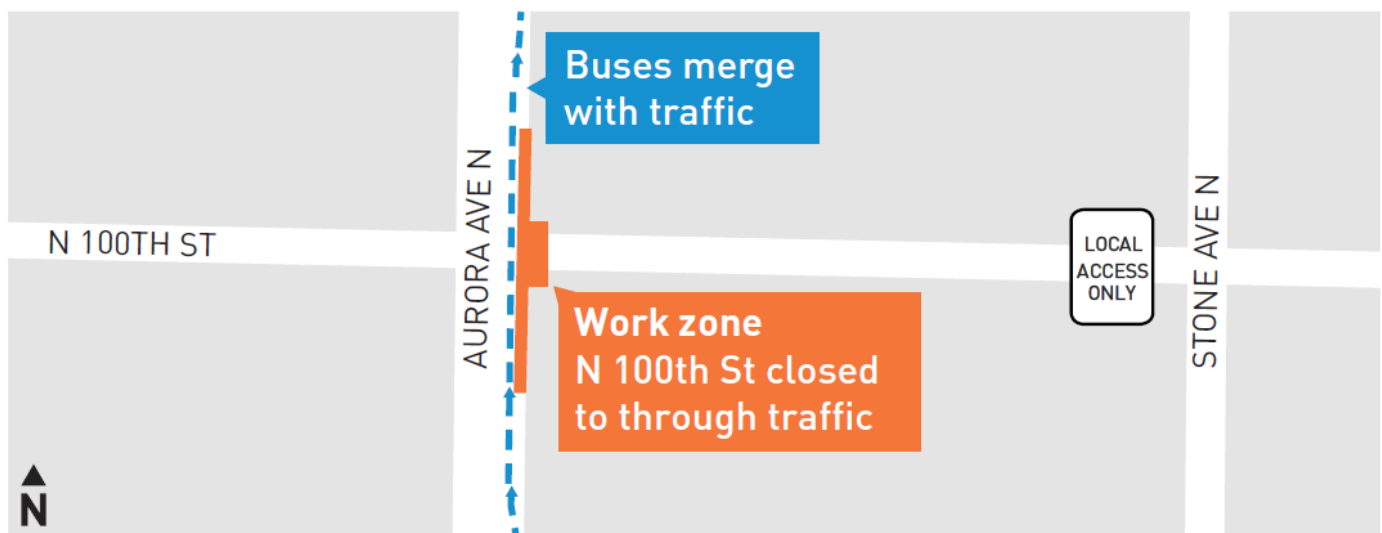

Roadway graphics are for illustration purposes only (not to scale).

CONTACT

Dan Anderson | Communications and Outreach Lead
northseattlegreenway@seattle.gov
(206) 684-8105
www.seattle.gov/transportation/NSeattleSafety.htm



Seattle
Department of
Transportation