

The first ravine bottom just below the viewpoint was the site of the early-day "Killman's Sand Burkers." The area was platted in 1907 by The Mayfair Land Co: Hj. Anderson, pres. and A. H. Soelberg, Secy.; Mayfair Ave. was named on the plat. The "bottom" land became the homesite of the John A. Lorentz family about 1920.

(Lorentz immigrated from Sweden in 1903, living first on "Lower" Queen Anne Hill. He developed the area and built many of the homes here.)

MAYFAIR is a fashionable district in London, east of Hyde Park, so named from an annual fair, held in May, until abolished in 1708. It is the name given to the Subdivision - and street - in this vicinity in 1907 by Hj. Anderson and A. H. Soelberg of The Mayfair Land Co.

### MAYFAIR PARK

1.0 Ac.

Purch. 1971 \$34,950 = A

2600 - 2ND AVE. No.

- Game tables
- Posts
- Climbers
- Slides
- Bridge
- Sand

2 M.T.  
 12' min  
 hose conn.  
 power pole

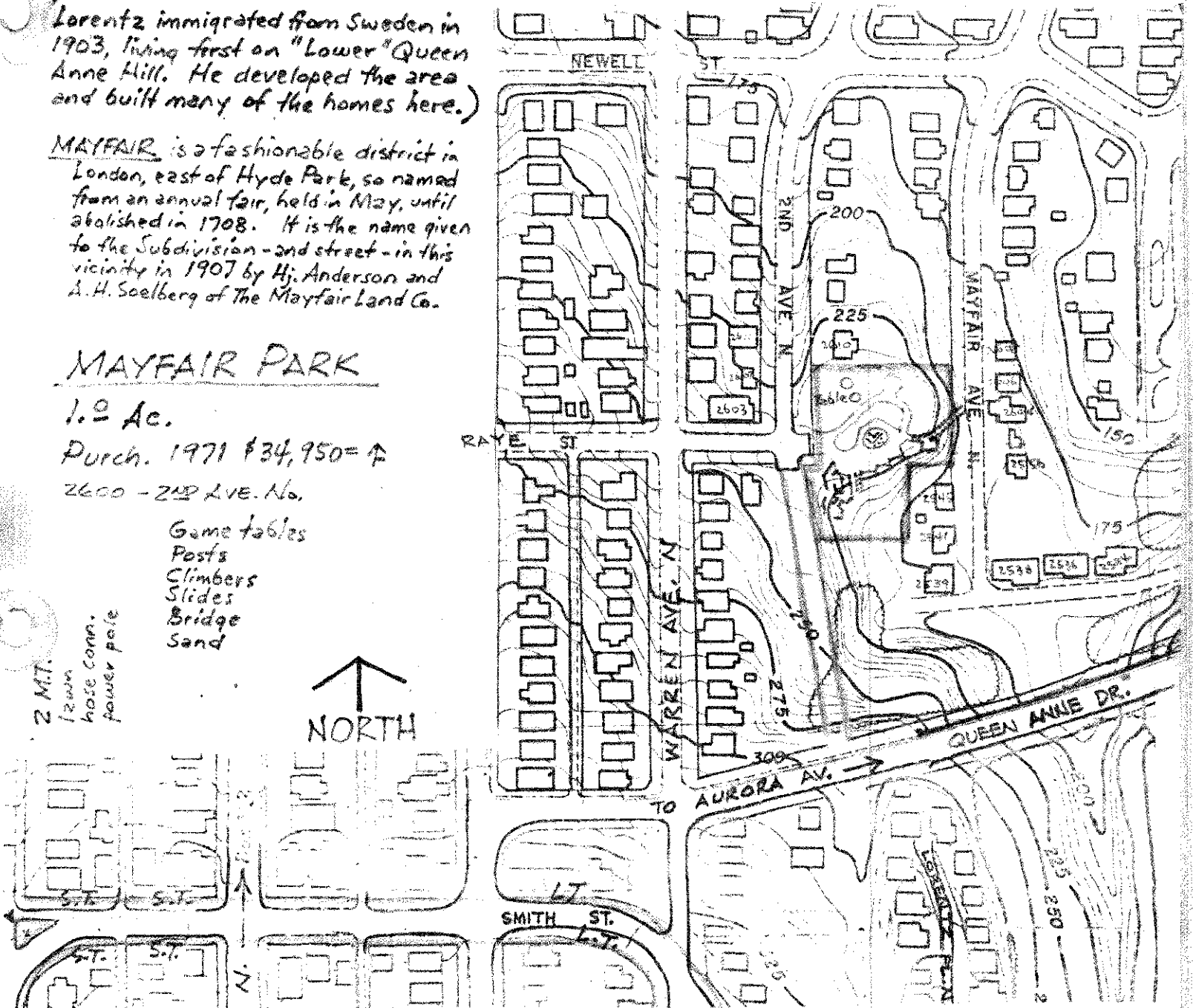

### MAYFAIR PARK

Johnson  
 donated part  
 North side of  
 Queen Anne  
 839-3612 Kevin