

**KINNEAR PARK** named for donors: Mrs. W. C. Kinnear  
(See History)  
**MERCER PL.** named for Thos. Mercer, pioneer homesteader:  
 pioneer road down hill to beach, north on trestle past  
 Interbay, on to Ballard.  
**OLYMPIC PL.** named for range of mountains seen from here,  
 across Puget Sound. Mt. Olympus named by Capt. John  
 Mears in 1780's, honoring the Macedonian peak famous in  
 Greek mythology as the abode of Zeus and his court of  
 12 Dieties. Capt. Geo. Vancouver extended the name to  
 "Olympic Mountain Range."

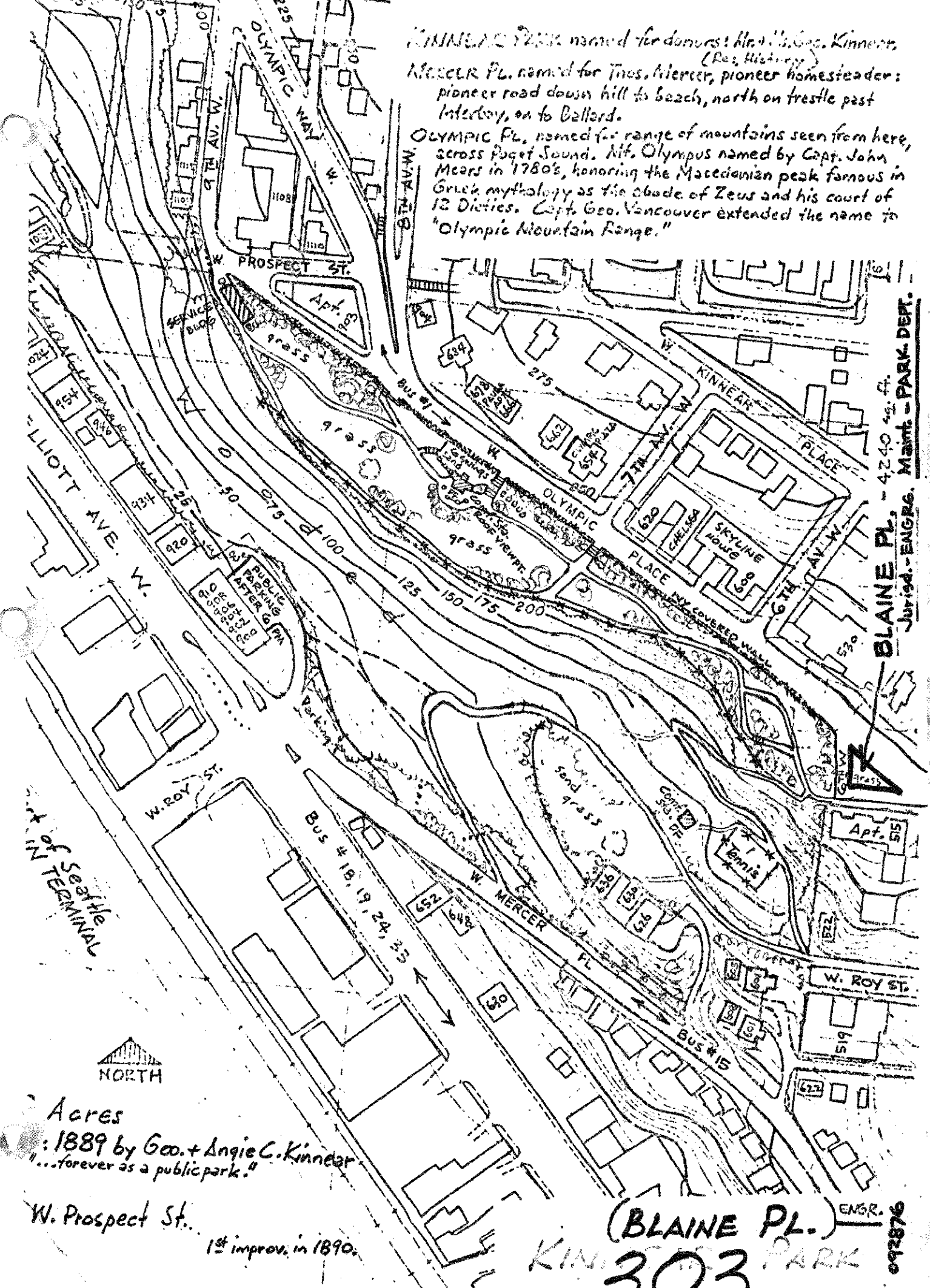

**BLAINE PL.** - 4240 sq. ft.  
 Jurisd. - ENGRS. Maint. - PARK DEPT.

Acres  
 : 1889 by Geo. + Angie C. Kinnear  
 "...forever as a public park."

W. Prospect St.  
 1st improv. in 1890.

(BLAINE PL.) ENGR.  
 303 PARK 092876